



AQUIFER
FILM STUDIO

STUDIO HIRE

AQUIFER FILM STUDIO

Film, Photography
and **Green** Screen
Cyclorama **Studio**
in East London



FEATURES



AQUIFER
FILM STUDIO



CYCLORAMA



BLACK-OUT



DRIVE-IN



GREEN SCREEN



24 / 7
ACCESS



ON-SITE
PARKING



HAIR &
MAKE-UP



THREE-PHASE
POWER



FIXED WIRED
LIGHTING GRID



KITCHEN &
LOUNGE



BALCONY ON
THE STAGE



360 CURTAIN
TRACK

OTHER FEATURES



FREE WIFI



ON SITE CAFE



PETROL STATION, 1 MIN DRIVE



CHANGING ROOM



WALKING DISTANCE TO SHOPS



EV CHARGING, 3 MIN DRIVE



SHOWER ROOM



TESCO, 4 MIN WALK



HOSPITAL, 7 MIN DRIVE



TOILET



SELF STORAGE, 1 MIN DRIVE



FIRE STATION, 14 MIN DRIVE



CYCLORAMA (White Infinity Cove Wall) STUDIO



BLACKOUT STUDIO

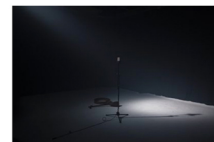



DRIVE-IN STUDIO



GREEN SCREEN STUDIO



GALLERY 3



AQUIFER
FILM STUDIO



FLOOR PLAN

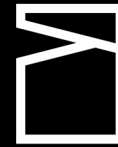

AQUIFER
FILM STUDIO

GROUND FLOOR:

- RECEPTION
- STAGE
- HALLWAY
- GREEN ROOM
- CHANGING AREA
- SHOWER ROOM
- TOILET

MEZZANINE FLOOR

- KITCHEN / LOUNGE
- GALLERY

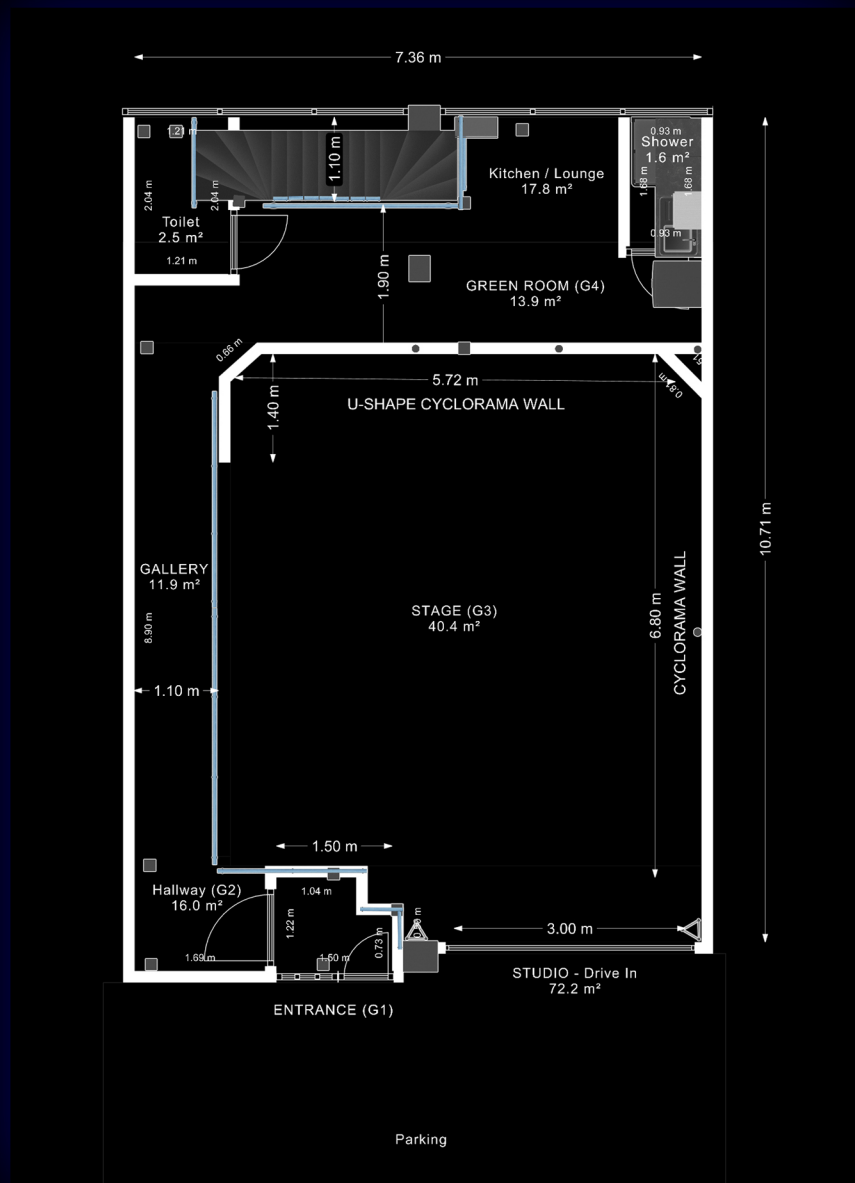



AQUIFER
FILM STUDIO

DIMENSIONS

STUDIO

Height: 4.3 m

Ground Floor: 80 sqm (861 sq ft)
Mezzanine: 30 sqm (322 sq ft)

Total Space: 110 sqm (1183 sq ft)

Dimension: 10.7m x 7.3m

STAGE

Height: 3.8 m

CYC area: 40 sqm (430 sq ft)

Dimension: 5.7 m x 6.8 m

LOCATION

TAKE

SOUND

DATE

SCENE

DIRECTOR

RATES

2 Hours (Per Session 8am-8pm) From £195.00 + VAT

3 Hours (Per Session 8am – 8pm) From £250.00 + VAT

Half Day (5 hours) From £395.00 + VAT

Full Day (10 Hours) From £675.00 + VAT

Full-Day Extended (12 Hours) From £785.00 + VAT

Over-Night / 12 Hours + Contact Us

24 / 7

- Overtime/additional time on the day - £90 + VAT p/h
- Overtime/additional time on the day (Unsociable hours, 10pm – 6am) - £110 + VAT p/h

NOTES



AQUIFER
FILM STUDIO

ALL BOOKINGS INCLUDE:

- 110 sqm (1180 sqft) Studio Space
- 40 sqm (430 sqft) U-shape cyclorama stage (6.8m x 5.7m) 4.3m height
- 3 Fixed LED TOPLIGHT (Chroma-Q Space Force onebytwo™ – soft 2800K – 6000K) with DMX controller
- Sony GTK-XB72 One-box sound system
- 2 x C-STANDS (300cm W127CM 2 x Boom Arm 4 x Grip head)
- 6 x SANDBAGS
- 3 x POLYBOARD and stands
- 32AMP 3-PHASE power with detachable Distribution box (RUBTR6)
- Wired lighting grid (16 amp and 13 amp)
- Hair and Make-up area – 2 Vanity tables with Hollywood mirrors
- Changing area
- Shower room and toilet
- Kitchen and lounge area with tea/coffee facilities
- High-speed Guest WiFi
- Ground floor roller shutter access

ADDITIONAL REQUIREMENTS:

DRIVE-IN Cars / Motorbikes	Included
GREEN SCREEN DRAPES (14m U-SHAPE)	Included
CHROMA GREEN FOAM MAT FLOORING (Up to 18 sqm)	Included
BLACK WOOL-SERGE DRAPES (12m U-SHAPE)	Included
BLACK VINYL FLOORING (6mx5m)	Included
PARKING SPACE PER CAR DAYLY	£15.00
COLORAMA BACKDROP PER 1 METER DAMAGED	£5.00
PAINTING STAGE TO GREEN / BLUE From	£600.00
GREEN SCREEN SET-UP AND PRE-LIT	£120.00

- All the above rates are subject to a 20% VAT

EQUIPMENT HIRE



AQUIFER
FILM STUDIO

DIRECTIONS



AQUIFER
FILM STUDIO

Car:

 A12, Old Ford Exit: 1 min

Bus:

 339 - Autumn Street (Stop QS): 1 min walk/drive

Underground:

 Bow Road station: 15 min walk / 5 min drive (0.9 miles)

 Bromley-By-Bow Station : 3 min drive / (0.9 miles)

Stratford station: 8 min drive (1.7 miles)

Overground:

 Hackney wick station: 18 min walk / 4 min drive (0.9 miles)

Stratford station: 8 min drive (1.7 miles)

DLR:

 Stratford station: 8 min drive (1.7 miles)

Boat:

 Liver Lea: 1 min walk

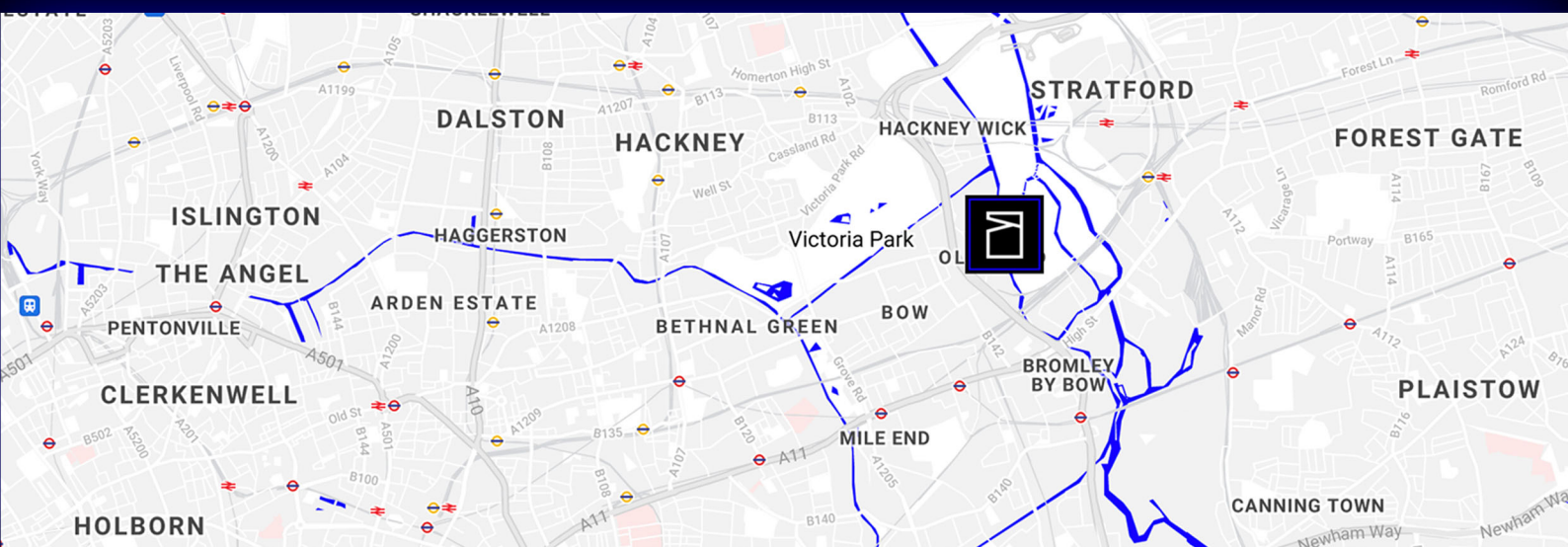



AQUIFER
FILM STUDIO

INFINITY COVE

[MORE INFO](#)

DRIVE IN

[MORE INFO](#)

BLACKOUT

[MORE INFO](#)

GREEN SCREEN

[MORE INFO](#)

PHOTOGRAPHY

[MORE INFO](#)

PRODUCTION TEAM

[MORE INFO](#)

CONTACT US



Phone:

020 8050 8212



Email:

studio@aquifer.film



Address:

Unit 10
Riverbank House
Dye House Lane
London
E3 2TB

